

AMERICAN MOTORS PARTS CATALOG

GROUP 13 HEATER - AIR CONDITIONING

DESCRIPTION	GROUP AND FIGURE NO.	GROUP NO.
BELT, Air Conditioning Compressor		13.425
BLADES, Heater and Defroster Motor	13-1	13.072
BRACE, Heat Distribution Duct	13-2	13.113
BRACE, Instrument Panel to Plate	13-3	13.488
BRACKET, Air Conditioning Compressor		13.410
CABLE, Heater and Defroster Air Damper Control		13.122
CLAMP, Heater Hose	2-1, 2-2	13.086
CLUTCH, Air Conditioning Compressor Drive		13.415
COMPRESSOR, Air Conditioning		13.400
CONTROL, Heater		13.017
CORE, Air Conditioning Condensor		13.450
CORE, Air Conditioning Evaporator		13.475
CORE, Heater	13-1	13.028
COVER, Heater Core	13-1	13.012
DAMPER, Air Conditioning Evaporator Defroster		13.500
DAMPER, Defroster Air Duct	13-2	13.120
DAMPER, Heater Air Inlet		13.015
DEFLECTOR, Heater Heat		13.008
DOOR, Air Conditioning Air Discharge Grille Outlet	13-5, 0-14	13.515
DUCT, Air Conditioning Evaporator to Discharge Grille	13-4	13.510
DUCT, Heat Distribution	13-2	13.113
DUCT, Heater and Defroster Air	13-2, 13-4	13.118
FILTER, Heater Air	13-1	13.002
GASKET, Air Conditioning Evaporator Plate	13-3	13.488
GASKET, Air Conditioning Evaporator to Discharge Grille Duct	13-4	13.510
GASKET, Heater Core	13-1	13.028
GASKET, Heater Core Cover	13-1	13.012
GRILLE, Air Conditioning Air Discharge	13-5	13.515
HEATER	13-1	13.001
HOSE, Air Conditioning		13.440
HOSE, Cowl Ventilator Drain		13.115
HOSE, Defroster	13-2, 13-4	13.108
HOSE, Heater	2-1, 2-2	13.082
HOSE, Heater Water Valve		13.050
HOUSING, Heater Core		13.012
INSULATION, Evaporator Housing Plate	13-3	13.488
KNOB, Heater and Defroster Switch		13.080
KNOB, Heater Water Valve Control Lever	0-14	13.052
MOTOR, Heater, Defroster and Air Conditioning	13-1	13.072
NIPPLE, Heater Hose	2-1, 2-2	13.088
NOZZLE, Defroster	13-2	13.110
PIN, Air Conditioning Air Discharge Grille Door Hinge	13-5	13.515
PLATE, Air Conditioning Evaporator	13-3	13.488
PULLEY, Air Conditioning Intermediate		13.430
RECEIVER, Air Conditioning		13.455
REINFORCEMENT, Heater and Defroster Motor Screen	13-1	13.072
ROD, Defroster Air Duct Damper	13-2	13.120
SCREEN, Heater and Defroster Motor	13-1	13.072
SHAFT, Heater Water Valve Control		13.053
SUPPORT, Heater and Defroster Motor	13-1	13.072
SWITCH, Heater, Defroster, Motor and Air Conditioning		13.078
THERMOSTAT, Temperature Control		13.477

AMERICAN MOTORS PARTS CATALOG

DESCRIPTION	GROUP AND FIGURE NO.	GROUP NO.
VALVE, Air Conditioning Expansion	13.470
VALVE, Compressor Suction and Discharge	13.405
VALVE, Heater Water	13.035

AMERICAN MOTORS PARTS CATALOG

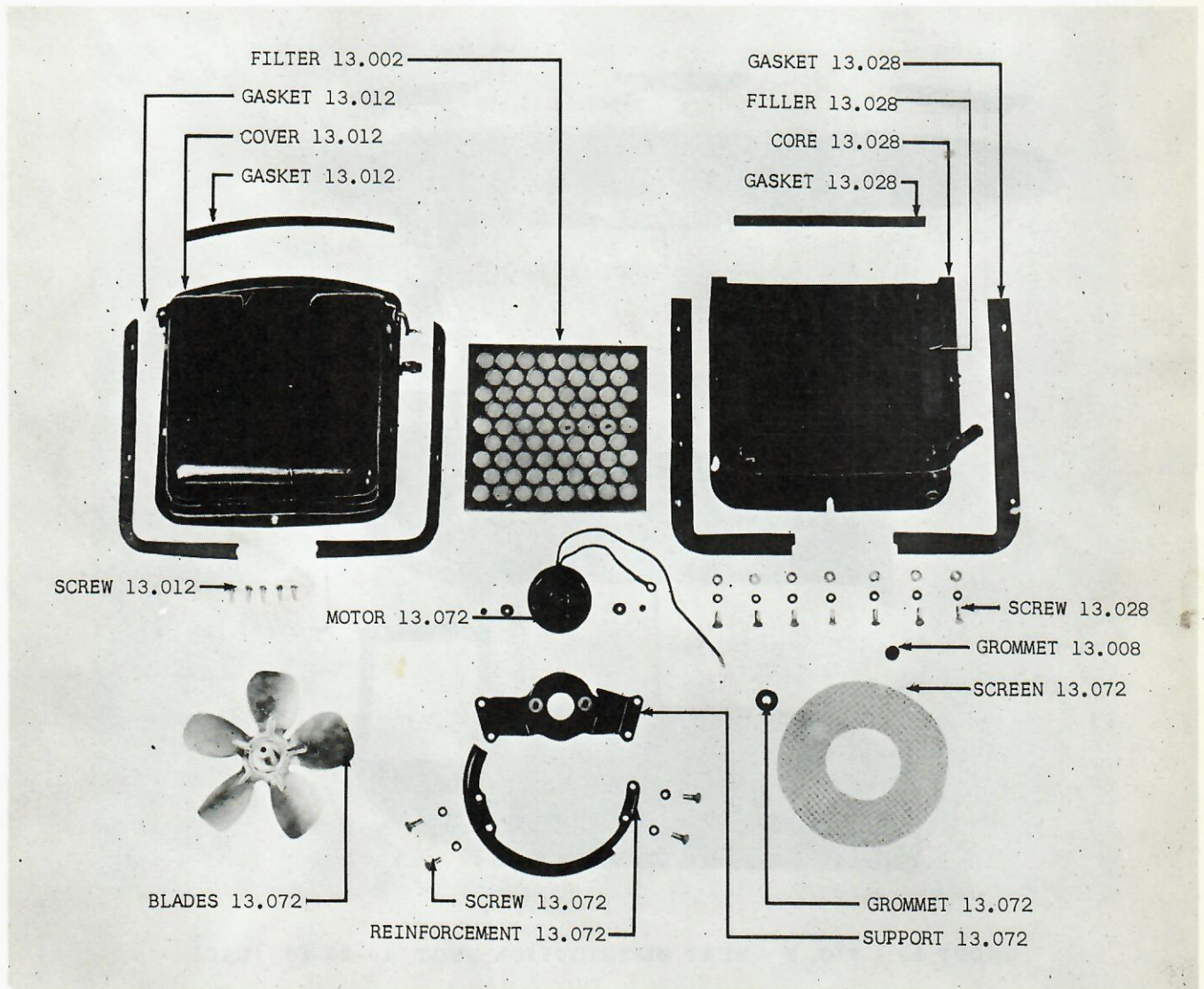

GROUP 13 - FIG. 1 - WEATHEREYE ASSEMBLY 01

AMERICAN MOTORS PARTS CATALOG

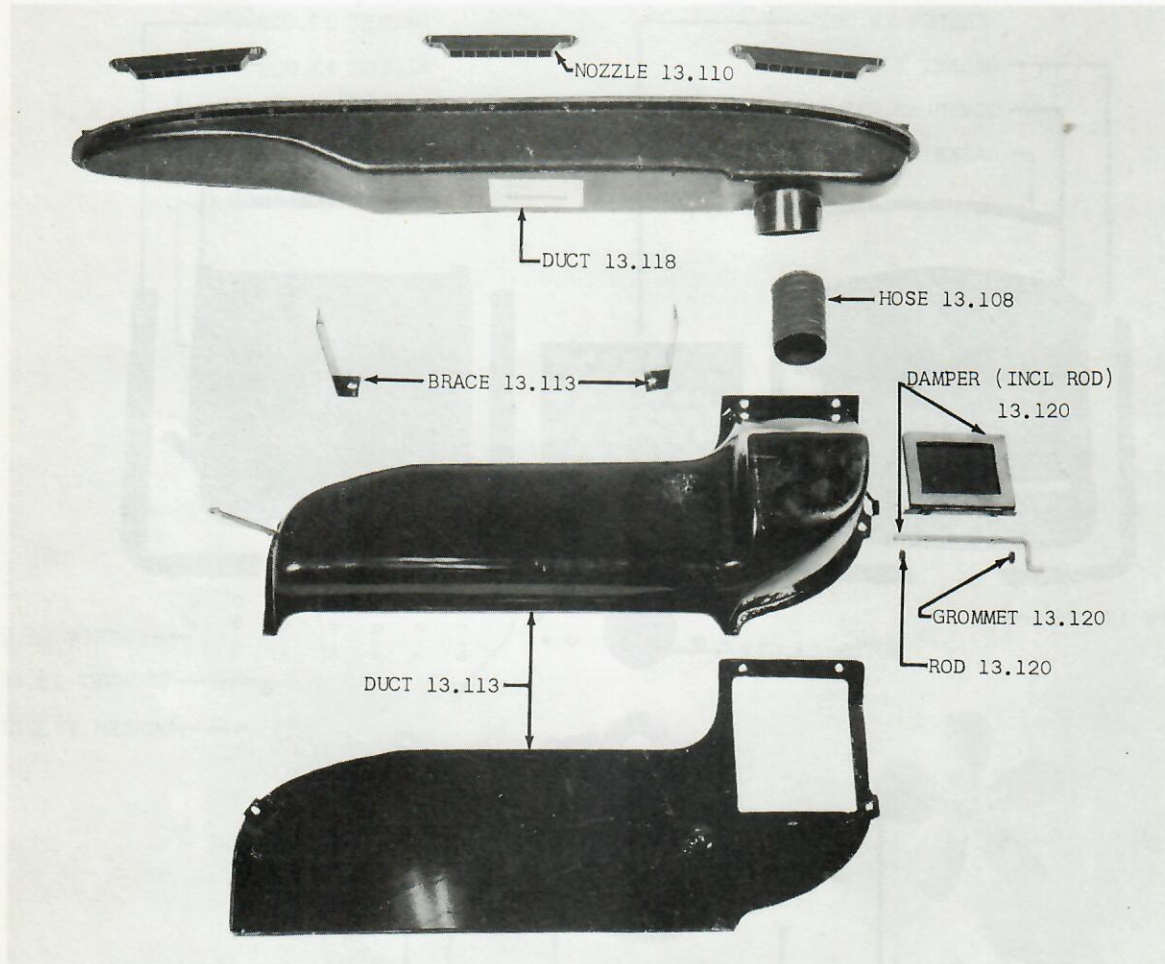

GROUP 13 - FIG. 2 - HEAT DISTRIBUTION DUCT 10-20-80 (LAC)

AMERICAN MOTORS PARTS CATALOG

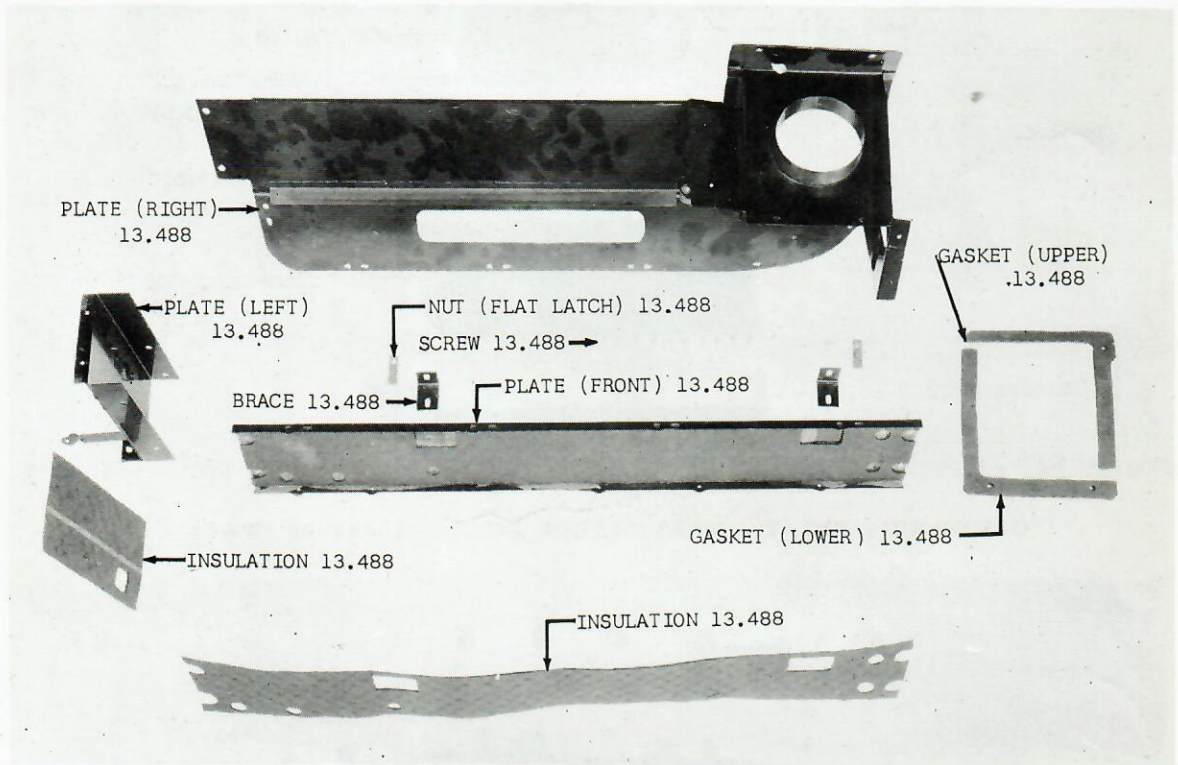

GROUP 13 - FIG. 3 - EVAPORATOR HOUSING PLATE 10-20-80 (WAC)

AMERICAN MOTORS PARTS CATALOG

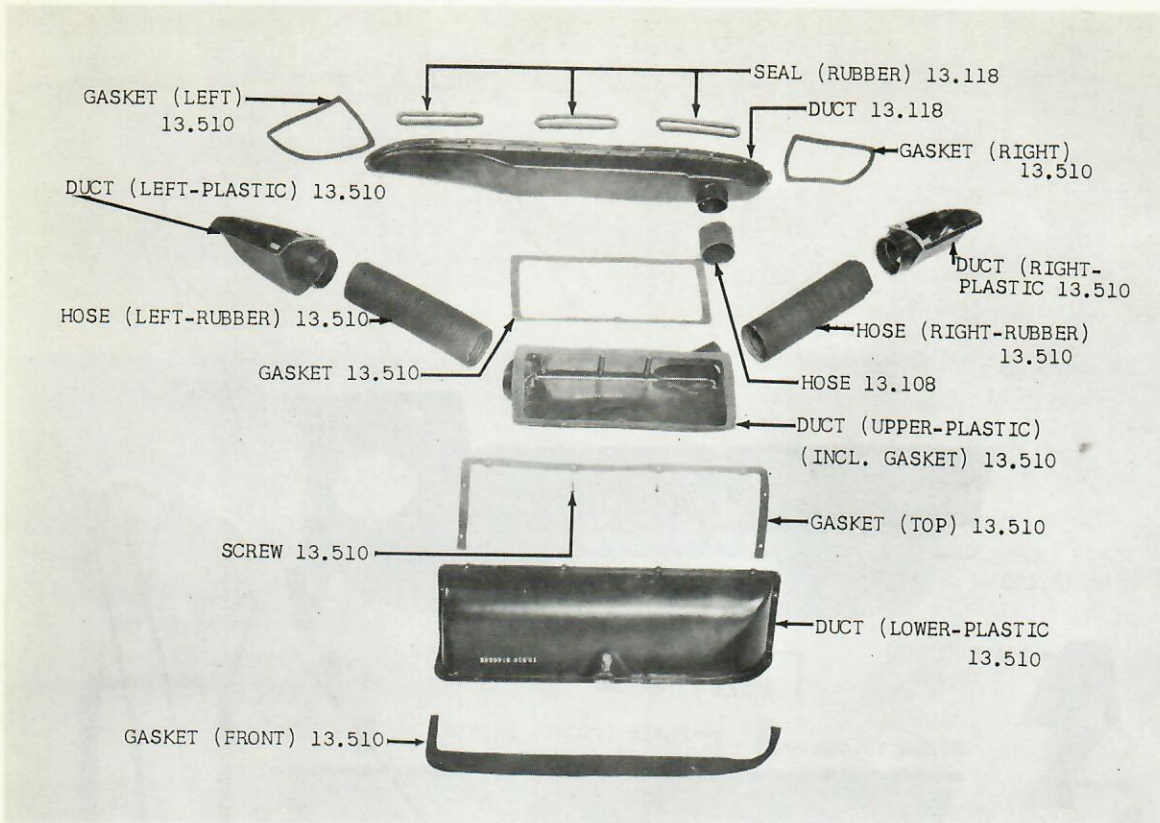

GROUP 13 - FIG. 4 - EVAPORATOR DUCTS 10-20-80 (WAC)

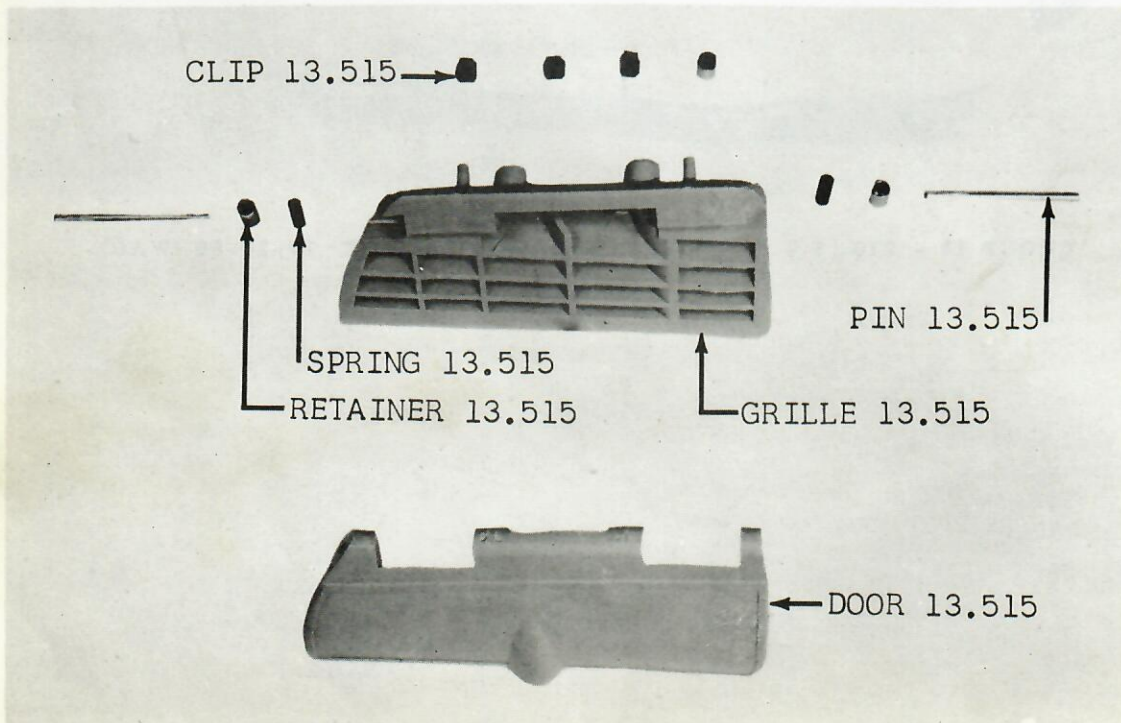

GROUP 13 - FIG. 5 - AIR CONDITIONING AIR DISCHARGE GRILLE 10-20-80 (WAC)

AMERICAN MOTORS PARTS CATALOG

13.012

DESCRIPTION	YEAR AND MODEL	PER CAR	PART NO.
-------------	----------------	---------	----------

GROUP 13 HEATER - AIR CONDITIONING

13.001 HEATER

WEATHEREYE.....	59 01 (LAC).....	1	320 1461
	59 10-20-80 (LHD-LAC).....	1	320 1459
	59 10-80 (RHD-LAC).....	1	320 1460

13.002 FILTER, Heater Air

FILTER.....	59 01.....	1	313 0088
	59 10-20-80.....	1	315 0191
SPRING.....	59 10-20-80.....	2	341 6979
SCREW.....	59 01.....	3	436 5309

13.008 DEFLECTOR, Heater Heat

DEFLECTOR.....	59 01.....	1	313 8224
SCREW (#10 - 12 x 1/2).....	59 01.....	2	G186469
(#10 - 12 x 3/4).....	59 01.....	1	G161651

13.012 COVER - HOUSING, Heater Core

COVER.....	59 01.....	1	314 3407
(Incl. Upper And Lower Gaskets).....	59 10-20-80.....	1	315 1246
HOUSING, Blower (Plastic).....	59 10-20-80.....	1	342 6375
PLATE (In Dash Panel)(Less Heater).....	59 10-20-80.....	1	343 0295
Tube Opening (Less Heater).....	59 10-20-80.....	1	315 0402
GASKET.....	59 01.....	1	313 6619
Core Cover (Less Heater)(Side).....	59 01.....	2	313 0076
(Upper).....	59 01.....	1	313 0079
(Upper)(18 17/32" Length)(Rubber).....	59 10-20-80.....	1	315 0181
(Lower)(19" Length)(Rubber).....	59 10-20-80.....	1	315 0180
Blower Housing ("U" Shape)(Rear).....	59 10-20-80.....	1	342 6380
(Round)(Rear).....	59 10-20-80.....	2	342 6379
Tube Opening.....	59 10-20-80.....	1	315 0576
Hole Plate To Dash Panel (Less Heater).....	59 10-20-80.....	1	343 0296
SPACER (Less Heater).....	59 01.....	1	313 0592
INSULATION (17 1/32" Length).....	59 10-20-80.....	1	315 0507
SCREW (#10 - 12 x 5/8).....	59 01.....	1	800 0095
(1/4 - 20 x 4).....	59 01.....	4	800 0049
(1/4 - 20 x 3/4).....	59 01.....	2	G180020
To Hopper Box.....	59 10 (10 Req.): 59 20-80 (9 Req.).....	AR	800 0093
Blower Housing To Heater Box.....	59 10-20-80.....	5	438 6577
To Dash Panel.....	59 10-20-80.....	2	G161930
Tube Opening Plate (Less Heater).....	59 10-20-80.....	1	800 0093
Hole Plate To Dash Panel (Less Heater).....	59 10-20-80.....	2	800 0093
WASHER (Plain)(9/32 x 5/8 x 1/16).....	59 01.....	5	G120392
(Lock)(1/4 x 1/2 External).....	59 01.....	4	G121753
(1/4 x 1/2 Spring).....	59 01.....	1	G120380
NUT (Speed).....	59 01.....	1	310 3117
	59 10-20-80.....	2	312 6533

AMERICAN MOTORS PARTS CATALOG

13.015 DAMPER, Heater Air Inlet

DAMPER (Less Rod)(16 5/16" Length).....	59 10-20-80 (LAC).....	1	314 6673
(Incl. Rubber			
Insert)...	59 10-20-80 (WAC).....	1	314 6784
ROD.....	59 10-20-80.....	1	343 5642
BRACKET, Rod.....	59 10-20-80.....	1	314 6238
GROMMET, Rod.....	59 10-20-80.....	1	438 6559
CUSHION (9/16" Square)(Rubber).....	59 10-20-80.....	2	341 6791
SCREW, Damper To Rod.....	59 10-20-80.....	2	G186469
Rod Bracket To Dash.....	59 10-20-80.....	2	G161895
WASHER (Plain), Damper.....	59 10-20-80.....	2	800 0145

13.017 CONTROL, Heater

CONTROL (Less Cable).....	59 10-20-80.....	1	320 0920
CABLE, Water Valve.....	59 10-20-80 (LHD).....	1	320 1408
	59 10-80 (RHD).....	1	320 1409
KNOB (Chrome).....	59 10-20-80.....	1	342 2227
SCREW.....	59 10-20-80.....	2	G187303
Knob To Control.....	59 10-20-80.....	1	G134168

13.020 DIAPHRAGM, Heater Damper Control

DIAPHRAGM (Incl. Link).....	59 10-20-80.....	1	343 8756
HOSE, Switch To Tee.....	59 10-20-80 (LHD).....	1	343 5193
	59 10-80 (RHD).....	1	343 7623
To Diaphragm.....	59 10-20-80 (LHD).....	1	343 5192
	59 10-80 (RHD).....	1	343 7603
TEE, Hose.....	59 10-20-80.....	1	343 8786
BRACKET.....	59 10-20-80.....	1	343 5643
CAP, Link Retainer.....	59 10-20-80.....	1	343 5026
SCREW, Bracket (#10 - 32 x 5/8).....	59 10-20-80.....	2	G273511
(#12 - 10 x 5/8).....	59 10-20-80.....	2	800 0122
(#14 - 10 x 5/8).....	59 10-20-80.....	2	800 0103
WASHER, Bracket.....	59 10-20-80.....	2	G120391
NUT, Bracket.....	59 10-20-80.....	2	G120614
Diaphragm.....	59 10-20-80.....	2	G271169

13.028 CORE, Heater

CORE.....	59 01.....	1	313 0093
	59 10-20-80.....	1	315 0205
SUPPORT (Right).....	59 10.....	1	341 0147
GASKET (Side).....	59 01.....	2	313 0076
(Top).....	59 01.....	1	313 0079
(Lower End).....	59 10-20-80.....	2	314 6619
FILLER (Rubber).....	59 01.....	2	313 1164
SEAL, Support.....	59 10-20-80.....	1	314 6319
PLATE, Tube Opening.....	59 10-20-80.....	1	315 0204
SCREW (1/4 - 20 x 3/4).....	59 01.....	2	G180020
(1/4 - 20 x 4).....	59 01.....	4	800 0049
(#10 - 12 x 5/8).....	59 01.....	1	800 0095
Support.....	59 10-20-80.....	2	800 0091
Plate To Core.....	59 10-20-80.....	1	800 0093
WASHER (Plain)(9/32 x 5/8 x 1/16).....	59 01.....	5	G120392
(Lock)(1/4 x 1/2 External).....	59 01.....	4	G121753
NUT, Speed.....	59 01.....	1	310 3117

AMERICAN MOTORS PARTS CATALOG

13.072

13.035 VALVE, Heater Water

VALVE.....	59 01.....	1	315 5866
	59 10-20-80.....	1	343 7604
GASKET, Opening Cover (Less Heater).....	59 10-20-80.....	1	313 1285
SEAL.....	59 10-20-80.....	2	342 5598
SPACER.....	59 10-20-80.....	2	342 9658
COVER (Less Heater).....	59 10-20-80.....	1	313 1284
SCREW.....	59 10-20-80.....	2	800 0099
Cover (Less Heater).....	59 10-20-80.....	2	800 0095
Capillary Tube.....	59 10-20-80.....	2	G161895
CLIP, Capillary Tube.....	59 10-20-80.....	1	312 6393

13.050 HOSE, Heater Water Valve

HOSE (Bulk)(Order In Feet).....	59 10-20-80.....	AR	375 0497
---------------------------------	------------------	----	----------

13.052 KNOB, Heater Water Valve

KNOB (Less Shaft).....	59 01.....	1	343 1773
	59 10-20-80.....	1	342 2227
SCREW.....	59 10-20-80.....	1	G134168

13.053 SHAFT, Heater Water Valve

SHAFT (Less Knob).....	59 01.....	1	342 5922
------------------------	------------	---	----------

13.072 BLOWER, Heater, Defroster And Air Conditiong

MOTOR.....	59 01 (OAC).....	1	320 1601
	59 10-20-80 (LAC).....	1	315 6027
	59 10-20-80 (WAC).....	1	314 5960
(Incl. Support).....	59 01.....	1	315 4772
BLADES.....	59 01.....	1	313 0136
	59 01 (OAC).....	1	320 1602
	59 10-20-80.....	1	315 2607
WHEEL.....	59 01 (OAC).....	1	320 1656
GUARD, Blades.....	59 01.....	1	320 1987
SHROUD, Fan.....	59 10-20-80 (WAC).....	1	315 6620
RESISTOR.....	59 10-20 (WAC): 59 80.....	1	342 6387
STRAP.....	59 10-20-80.....	1	314 7393
WIRE (Double)(63" Length).....	59 01.....	1	313 8367
SUPPORT, Motor.....	59 01.....	1	313 0084
SCREEN.....	59 10-20-80.....	1	314 7288
INSULATOR.....	59 01.....	1	313 0270
GROMMET, Screen.....	59 10-20-80 (LAC).....	1	343 8784
Wire.....	59 10-20-80 (WAC).....	1	314 3831
(Less Heater).....	59 10-20-80.....	1	438 6636
REINFORCEMENT, Screen.....	59 01.....	1	313 0082
COVER, Blower Opening (Less Heater).....	59 10-20-80.....	1	343 0084
CONNECTOR, Wire.....	59 10-20-80.....	2	312 7171
SCREW, Support (1/4 - 20 x 3/4).....	59 01.....	1	G180020
(1/4 - 20 x 5/8).....	59 01.....	2	G180018
Cover (Less Heater).....	59 10-20-80.....	1	438 6577
Resistor.....	59 10-20-80 (WAC).....	2	G445656
WASHER (Plain).....	59 10-20-80.....	4	G120391
(Lock).....	59 10-20-80.....	2	G138479
NUT.....	59 10-20-80.....	2	G120614

AMERICAN MOTORS PARTS CATALOG

13.078 SWITCH, Heater, Defroster And Air Conditioning Motor

SWITCH.....	59 01.....	1	343 1772
	59 10-20-80.....	1	343 5646 ✓
Temperature Control.....	59 01 (OAC).....	1	320 1606
Blower Control.....	59 01 (OAC).....	1	320 1605
WIRE, Switch To Clutch.....	59 01 (OAC).....	1	320 1988
BUTTON (Less Heater).....	59 01.....	1	313 1243
SPACER, Bolt (Less Heater).....	59 10-20-80.....	1	342 1955
BOLT (Less Heater).....	59 10-20-80.....	1	314 7440
WASHER (Lock), Plug (Less Heater).....	59 10-20-80.....	1	G120214
NUT, Retainer.....	59 01-10-20-80.....	1	312 8826
Plug (Less Heater).....	59 10-20-80.....	1	G120368

13.080 KNOB, Heater, Defroster And Air Conditioning Switch

KNOB.....	59 01.....	1	343 1773
	59 10-20 (LAC): 59 80 (Deluxe).....	1	342 2232
	59 10-20 (WAC).....	1	343 5519
	59 80.....	1	343 0339
(Temperature And Blower).....	59 01 (OAC).....	2	320 1607
SCREW, Set.....	59 01.....	1	341 6806
	59 10-20-80.....	1	320 1042

13.082 HOSE, Heater

HOSE (To Core).....	59 10-20-80.....	1	315 1597
(Bulk)(Order In Feet).....	59 01-10-20-80.....	AR	375 0497
CLIP (1 On Valve Cover)(1 On Heater Box).....	59 10 (Note 3.005-1).....	2	314 7731
SPACER, Clip (On Heater Box).....	59 10 (Note 3.005-1).....	1	313 0118
SCREW, Clip To Heater Box.....	59 10 (Note 3.005-1).....	1	800 0099
WASHER, Clip To Heater Box.....	59 10 (Note 3.005-1).....	1	800 0139

13.086 CLAMP, Heater Hose

CLAMP.....	59 01-10-20-80.....	AR	G111606
------------	---------------------	----	---------

13.088 NIPPLE, Heater Hose

NIPPLE (In Water Pump).....	59 01-20-80.....	1	315 1365
	59 10.....	1	314 2368
	59 20-80 (WAC).....	1	G192071
(In Cylinder Head).....	59 10.....	1	314 2364
	59 20.....	1	314 2367
	59 80.....	1	315 1365
ELBOW (Steel)(45° Pipe).....	59 20-80 (WAC).....	1	G144136
(Brass)(45°).....	59 20-80 (WAC).....	1	315 3782

13.108 HOSE, Defroster

HOSE.....	59 01.....	2	437 3242
	59 10-20-80.....	2	314 6781

13.110 NOZZLE, Defroster

NOZZLE.....	59 01.....	2	437 3244
(Black).....	59 10-20-80.....	3	341 7558
(Blue).....	59 10-20-80.....	3	343 4725
(Green).....	59 10-20-80.....	3	343 4726
(Copper).....	59 10-20-80.....	3	343 9440

AMERICAN MOTORS PARTS CATALOG

13.400

ESCUTCHEON (W/Instru. Panel Pad)(Black).....	59 10-20-80.....	3	344 5877
(Blue).....	59 10-20-80.....	3	344 5878
(Green).....	59 10-20-80.....	3	344 5879
(Copper).....	59 10-20-80.....	3	344 5880
SCREW.....	59 10-20-80.....	6	G162013

13.113 DUCT, Heat Distribution

DUCT.....	59 10-20-80 (LHD-LAC).....	1	342 5577
	59 10-80 (RHD-LAC).....	1	342 5578
GASKET (Upper).....	59 10-20-80 (LAC).....	1	342 5585
(Lower).....	59 10-20-80 (LAC).....	1	342 5586
SCREW, To Dash.....	59 10-20-80 (LAC).....	4	G162013

13.115 HOSE, Cowl Ventilator Drain

HOSE.....	59 01: 59 10-20-80 (Note 13.115-1 Type 1)....	1	313 0977
	59 10-20-80 (Note 13.115-1 Type 2).....	1	343 6204

13.118 DUCT, Heater And Defroster Air

DUCT (Plastic)(Incl. Cover)(36" Length)(Less Nozzles).....	59 10-20-80.....	1	341 1927
SEAL, To Instrument Panel (6-1/2" Length).....	59 10-20-80.....	3	341 1873
SCREW.....	59 10-20-80.....	6	G148573
NUT.....	59 10-20-80.....	6	341 1872

13.120 DAMPER, Defroster Air Duct

DAMPER (Less Rod).....	59 10-20-80 (LAC).....	1	314 6674
	59 10-20-80 (WAC).....	1	342 5565
ROD.....	59 10-20-80.....	1	342 5820
GROMMET, Rod.....	59 10-20-80.....	2	438 6559
SCREW, Rod To Door.....	59 10-20-80.....	2	G155103
WASHER (Lock), Rod.....	59 10-20-80.....	2	G131096

13.122 CABLE, Defroster Damper

CABLE (Incl. Black Knob).....	59 10-20 (LHD): 59 80 (Deluxe).....	1	342 8495
	59 10 (RHD).....	1	342 9746
(Incl. Chrome Knob).....	59 80 (LHD).....	1	342 2228
	59 80 (RHD).....	1	342 8534
CLIP, Retainer.....	59 10-20-80.....	2	310 9459
SPACER.....	59 10-20-80.....	1	342 1955
CLAMP, Cable.....	59 10-20-80.....	2	313 0267
SCREW, Clamp.....	59 10-20-80.....	1	G161790
NUT, Jam.....	59 10-20-80.....	1	G272123

13.400 COMPRESSOR, Air Conditioning

COMPRESSOR.....	59 01.....	1	315 7173
	59 10-20-80.....	1	315 0409
SEAL KIT.....	59 10-20-80.....	1	311 9126
	59 01.....	1	320 1706
VALVE PLATE KIT.....	59 10-20-80.....	1	311 8919
	59 01.....	1	320 1705

NOTE 13.115-1: Two Types of Drain Hoses were used on the 59 10-20-80 Series. They can be identified as follows:

- Type 1: Hose fits on Brass Drain Tube in Air Chamber.
- Type 2: Hose fits thru Drain Hole in Air Chamber.

AMERICAN MOTORS PARTS CATALOG

GASKET KIT.....	59 10-20-80.....	1	311 8920
	59 01.....	1	320 1707
CARBON NOSE, Seal Kit.....	59 10-20-80.....	1	311 9658
"O" RING, Seal Kit.....	59 10-20-80.....	1	311 9659
(In Bellows).....	59 10-20-80.....	1	320 0802
Rear Bearing Plate.....	59 10-20-80.....	1	320 1415

13.405 VALVE, Air Conditioning Compressor Charging And Discharging

VALVE (Freon Charging).....	59 01-10-20-80.....	1	315 3310
(Suction)(Equipped For Quick Disconnect Coupling).....	59 01.....	1	315 7175
(Not Equipped For Quick Disconnect Coupling).....	59 01.....	1	315 7176
(Discharge).....	59 01.....	1	315 7176
	59 10-20-80.....	1	311 8742
CAP, Freon Charging Valve.....	59 01-10-20-80.....	1	315 3725
FITTING, Suction.....	59 10-20-80.....	1	315 3775
GASKET, Valve Mounting.....	59 01.....	2	315 7174
	59 10-20-80.....	2	314 9414
Freon Charging Valve.....	59 01-10-20-80.....	1	315 6005
KEY.....	59 01-10-20-80.....	1	314 9417
SCREEN, Suction Valve.....	59 10-20-80.....	1	314 9415
SCREW (Socket Head).....	59 01-10-20-80.....	4	314 9418

13.410 BRACKET, Air Conditioning Compressor

BRACKET (Support).....	59 01.....	1	315 7177
(Mounting).....	59 01.....	1	315 7178
To Cylinder Head.....	59 10.....	1	314 6842
Adjusting Plate.....	59 10.....	1	314 6843
(Front)(To Water Manifold).....	59 20-80.....	1	315 0350
(Rear)(To Intake Manifold).....	59 20-80.....	1	315 0351
BRACE, To Cylinder Head (Short Angle).....	59 20-80.....	1	315 7607
ROD, Brace (8-9/32" Length).....	59 10.....	1	314 8954
BOLT, To Cylinder Head (3/8 - 16 x 1).....	59 10.....	2	G180122
To Spacer Plate (5/16 - 24 x 2).....	59 10.....	1	G181620
(5/16 - 24 x 1-1/2).....	59 10.....	2	G181614
To Compressor (3/8 - 16 x 1-1/8).....	59 10.....	2	G179840
(3/8 - 16 x 1-5/8).....	59 10.....	1	G179844
(3/8 - 16 x 3/4).....	59 20-80.....	4	G180120
Compressor To Mounting Bracket.....	59 01.....	2	G180121
To Manifold (3/8 - 16 x 3/4).....	59 20-80.....	3	G180120
To Adjusting Bracket (3/8 - 16 x 1).....	59 10.....	1	G180122
Rod To Compressor (3/8 - 16 x 7/8).....	59 10.....	1	G180121
SCREW, Brace To Compressor.....	59 20-80.....	1	G181697
To Cylinder Head.....	59 20-80.....	1	G180120
STUD, Adjusting Plate Bracket.....	59 10.....	3	312 9733
WASHER (Plain), To Cylinder Head.....	59 10.....	2	800 0163
To Spacer Plate.....	59 10.....	3	G120393
Rod To Compressor.....	59 10.....	2	800 0161
(At Intake Manifold)(Lower).....	59 20-80.....	1	800 0165
(Upper).....	59 20-80.....	1	800 0163
(Lock), To Cylinder Head.....	59 10.....	2	G120382
To Compressor.....	59 10-20-80.....	4	G120382
Rod To Compressor.....	59 10.....	1	G120382

AMERICAN MOTORS PARTS CATALOG

13.430

Brace To Compressor (1/2 x 7/8).	59 20-80.....		1	G120384
(17/32 x 1).	59 20-80.....		2	800 0193
To Cyl. Head (3/8 x 11/16)	59 20-80.....		1	G120382
Compressor To Mounting Bracket..	59 01.....		3	G120382
To Support Bracket...	59 01.....		2	G120382
NUT, To Bracket Support.....	59 01.....		2	G120369

13.415 CLUTCH, Air Conditioning Compressor Drive

PLATE, Drive (Driven).....	59 01-10-20-80.....		1	320 0598
PULLEY, Drive.....	59 10.....		1	320 0599
	59 01-20-80.....		1	320 0600
BEARING, Pulley.....	59 01-10-20-80.....		1	320 0221
RING, Pulley Bearing Snap.....	59 01-10-20-80.....		1	320 0603
BRUSHES (Incl. Holder).....	59 01.....		1	315 7226
	59 10-20-80.....		1	315 2225
RETAINER, Bearing.....	59 01-10-20-80.....		1	320 0222
BOLT, To Compressor.....	59 01-10-20-80.....		1	314 9426
SCREW, Brushes.....	59 01-10-20-80.....		2	G443639
KEY, Mounting.....	59 01-10-20-80.....		1	314 9417
WASHER, To Compressor.....	59 01-10-20-80.....		1	314 1414
(Lock), To Compressor.....	59 01-10-20-80.....		1	G120214
Brushes.....	59 01-10-20-80.....		2	G120380

13.425 BELT, Air Conditioning Compressor

BELT.....	59 01.....		1	315 7183
	59 20-80.....		1	315 4659
(Crankshaft To Intermediate Or Power Steering Pump Pulley).....	59 10.....		1	314 6840
(Intermediate Or Power Steering Pump Pulley To Compressor Clutch).....	59 10.....		1	314 6839
SPACER, Adjusting.....	59 01.....		1	315 7179
SCREW, Adjusting.....	59 01.....		1	G180128
WASHER (Plain).....	59 01.....		1	G120382
(Lock).....	59 01.....		1	G120394

13.430 PULLEY, Air Conditioning Intermediate

PULLEY (Incl. Bearing And Hub).....	59 10 (LPS).....		1	314 7015
(Incl. Bearing And Shaft).....	59 20-80 (LPS).....		1	314 3732
PLATE, Adjusting.....	59 10 (LPS).....		1	314 6976
Housing.....	59 10 (LPS).....		1	314 7014
ADAPTER.....	59 20-80 (LPS).....		1	315 3533
BRACKET, Adapter To Cylinder Head.....	59 20-80 (LPS).....		1	315 3535
SPACER, Pulley To Adapter.....	59 20-80 (LPS).....		1	313 8793
BOLT, Housing To Adjusting Plate.....	59 10 (LPS).....		3	G181637
Adapter To Bracket.....	59 20-80 (LPS).....		2	G179839
Hub To Adjusting Plate.....	59 10 (LPS).....		4	G181593
WASHER (Plain), Adj. Brkt. (13/32 x 7/8 x 1/8).	59 10 (LPS).....		1	800 0165
(13/32 x 1-7/8 x 3/16).....	59 10 (LPS).....		2	314 6964
Adapter To Bracket.....	59 20-80 (LPS).....		2	800 0167
(Lock), Housing To Adjusting Plate.....	59 10 (LPS).....		3	G120382
Hub To Adjusting Plate.....	59 10 (LPS).....		4	G120214
Adjusting Bracket.....	59 10 (LPS).....		3	G120382
Pulley To Adapter.....	59 20-80 (LPS).....		1	311 8257
Adapter To Bracket.....	59 20-80 (LPS).....		2	G138489

AMERICAN MOTORS PARTS CATALOG

NUT, Housing To Adjusting Plate.....	59 10 (LPS).....	3	G120369
Adjusting Bracket.....	59 10 (LPS).....	3	G120369
Pulley To Adapter.....	59 20-80 (LPS).....	1	G120370

13.440 HOSE - TUBE, Air Conditioning

HOSE (Compressor To Condenser).....	59 01 (OAC).....	1	315 7180
	59 10 (WAC).....	1	315 3331
	59 20-80 (WAC).....	1	315 3330
(Evap. To Comp.)(Not Equipped For Quick Disconnect Coupling)...	59 01 (OAC): 59 10-20-80 (WAC).....	1	315 3961
(Equipped For Quick Disconnect Coupling)...	59 01 (OAC).....	1	315 7181
	59 10 (OAC).....	1	315 3777
	59 20-80 (OAC).....	1	315 8756
(Receiver To Evaporator).....	59 01 (OAC).....	2	315 7182
	59 10-20 (WAC).....	1	315 4515
	59 80 (WAC).....	1	315 4516
	59 10-20-80 (OAC).....	1	315 4514
COUPLING, Disconnect (Self Sealing)(Female Half).....	59 01-10-20-80 (OAC).....	2	315 3311
(Self Sealing)(Male Half).....	59 01-10-20-80 (OAC).....	2	315 3312
VALVE AND SEAL ASSEMBLY, Female Half Coupling..	59 01-10-20-80 (OAC).....	2	320 0833
POPPET VALVE ASSEMBLY, Male Half Coupling.....	59 01-10-20-80 (OAC).....	2	320 0832
RING, Disconnect Coupling (Rubber).....	59 01-10-20-80 (OAC).....	4	315 3314
GROMMET, Receiver To Evap. Hose (In Dash) (Round)(1-1/2" O.D.).....	59 10-20-80 (WAC).....	2	315 3438
Receiver To Evap. Hose (In Dash) (Oblong)(3-1/8" Length).....	59 10-20-80 (WAC).....	1	342 9655
Evap. To Comp. (In Dash).....	59 01 (OAC): 59 10-20-80 (WAC).....	1	315 3439
Suction Line (Right Side).....	59 10-20-80 (WAC).....	1	342 5521
INSULATION, Evap. Tube (Suction Line)(8x4x1/8) (20x4x1/8)	59 01 (OAC): 59 10-20-80 (WAC).....	1	315 5586
	59 01 (OAC).....	1	315 8337
BRACKET, Evap. To Receiver Hose Clip.....	59 80 (WAC).....	1	315 8227
CLIP, Evap. To Receiver Hose.....	59 20 (WAC).....	1	313 8580
(At Front Of W/H).....	59 01 (OAC).....	1	96 823
(At Rear Of W/H):..	59 01 (OAC).....	1	310 7341
(To Brace Rod Clip).....	59 80 (WAC).....	1	313 8580
Evap. To Compressor Hose.....	59 01 (OAC).....	1	310 7341
Comp. To Condenser Hose.....	59 01 (OAC).....	1	313 8580
On Cowl Brace Rod.....	59 80 (WAC).....	1	312 3849
SCREW, Evap. To Receiver Hose Clip.....	59 01 (OAC): 59 20 (WAC).....	1	800 0103
	59 80 (WAC).....	1	G180018
To Front Crossmember Clip.....	59 01 (OAC).....	1	800 0129
WASHER (Plain), Receiver To Evap. Hose Clip And Bracket.....	59 80 (WAC).....	1	G120392
(Lock), Receiver To Evap. Hose Clip And Bracket.....	59 80 (WAC).....	1	G120380
NUT, Receiver To Evap. Hose Clip.....	59 80 (WAC).....	1	G120375

13.450 CORE, Air Conditioning Condenser

CORE.....	59 01.....	1	315 7184
	59 10-20.....	1	315 4274
	59 80.....	1	315 3639
BRACKET, Tube Support (5-5/16" Length).....	59 80.....	1	315 6098
("L" Shaped).....	59 10-20-80.....	1	315 3673

AMERICAN MOTORS PARTS CATALOG

13.470

SPACER, To Radiator Core.....	59 10-20.....	4	315 3674
CLIP, Tube.....	59 10-20-80.....	1	312 3849
SCREW, Clip To Baffle.....	59 10-20.....	1	800 0093
	59 80.....	1	800 0127
BOLT, To Spacer.....	59 10-20.....	4	G181595
To Radiator Side Baffle.....	59 80.....	4	G181595
Spacer To Radiator Side Baffle.....	59 10-20.....	4	G181595
Tube To Bracket.....	59 10-20-80.....	1	G180018
Mounting (Upper).....	59 01.....	2	G181593
(Lower).....	59 01.....	2	G180016
WASHER (Plain), To Baffle.....	59 80.....	4	800 0153
Spacer To Baffle.....	59 10-20.....	8	800 0153
Tube To Bracket.....	59 10-20-80.....	1	G446188
(Lock), Spacer To Baffle.....	59 10-20.....	4	G120214
To Baffle.....	59 80.....	4	G120214
Tube To Bracket.....	59 10-20-80.....	1	G120380
Mounting (Upper).....	59 01.....	2	G120214
(Lower).....	59 01.....	2	G120380
NUT, Spacer To Baffle.....	59 10-20-80.....	4	G120368
Tube To Bracket.....	59 10-20-80.....	1	G120375
Mounting (Upper).....	59 01.....	2	G120368
(Lower).....	59 01.....	2	G120375

13.455 RECEIVER, Air Conditioning

RECEIVER.....	59 01 (OAC).....	1	315 7185
	59 10-20 (WAC).....	1	315 6198
	59 80 (WAC).....	1	315 6199
	59 10-20-80 (OAC).....	1	315 6200
REPAIR KIT, Check Valve.....	59 01-10-20-80.....	1	320 1293
VALVE, Pressure Relief.....	59 01-10-20-80.....	1	320 1430
BODY, Pressure Relief Valve.....	59 01-10-20-80.....	1	320 1296
Check Valve (1 Piece Unit)(Use 1-3201289, 1-3201292 And 1-3201571).	59 01-10-20-80		
(For 3 Piece Unit).....	59 10-20-80.....	1	320 1289
CAP, Pressure Relief Valve.....	59 01-10-20-80.....	1	320 1297
Check Valve (For 3 Piece Unit).....	59 10-20-80.....	1	320 1292
GUIDE, Check Valve.....	59 01-10-20-80.....	1	320 1291
GASKET, Pressure Relief Valve.....	59 01-10-20-80.....	1	320 1300
"O" RING, Check Valve Cap To Body (For 3 Piece Unit).....	59 01-10-20-80 (WAC).....	1	320 1571
CLIP, Receiver.....	59 10-20-80.....	1	314 4728
BRACKET, Clip.....	59 10-20 (WAC).....	1	315 6654
	59 10-20 (OAC): 59 80 (WAC).....	1	315 0579
BOLT.....	59 01.....	2	G180016
SCREW.....	59 10-20-80.....	2	G144727
Clip.....	59 10-20-80.....	1	G179819
WASHER (Plain), Clip.....	59 10-20-80.....	1	800 0153
(Lock).....	59 01.....	2	G120380
Clip.....	59 10-20-80.....	1	G120214
NUT.....	59 01.....	1	G120375
Clip.....	59 10-20-80.....	1	G120376

13.470 VALVE, Air Conditioning Expansion

VALVE.....	59 01.....	1	320 1603
	59 10-20-80.....	1	314 6783
SHIELD.....	59 10-20-80.....	1	314 6675

AMERICAN MOTORS PARTS CATALOG

SEAL, To Evaporator Core.....	59 10-20-80.....	1	314 7446
ATTACHING PARTS, Capillary Tube.....	59 10-20-80.....	1	320 1610
SCREW, Shield.....	59 10-20-80.....	2	800 0091
13.475 CORE, Air Conditioning Evaporator			
CORE.....	59 01 (OAC).....	1	320 1604
	59 10-20-80 (WAC).....	1	315 3924
	59 10-20-80 (OAC).....	1	315 3290
SEAL, To Expansion Valve.....	59 10-20-80.....	1	314 7446
13.477 THERMOSTAT, Air Conditioning Temperature Control			
THERMOSTAT.....	59 10-20-80.....	1	314 7050
WASHER (Lock).....	59 10-20-80.....	2	G131095
SCREW.....	59 10-20-80.....	2	G173028
13.488 PLATE - PAN, Air Conditioning Evaporator			
PLATE (Rear)(Defr. Door Is Attached To Plate)..	59 10-20-80.....	1	342 5584
(Left Side).....	59 10-20-80.....	1	315 5931
(Front).....	59 10-20-80.....	1	314 6475
HOUSING (Metal).....	59 01.....	1	320 1990
PANEL, Face (Plastic).....	59 01.....	1	320 1986
PAN, Drip (Plastic).....	59 01.....	1	315 7251
Drain (Metal).....	59 01.....	1	320 1658
PLATE, Lettering (Temp., Air And Off)(On Face)..	59 01.....	1	320 1991
LOUVER, Air Deflector.....	59 01.....	3	320 1655
GRILLE (Chrome).....	59 01.....	1	320 1654
PLATE, Trim (Front Of Evap.).....	59 01.....	1	320 1657
KNOB, Louvers.....	59 01.....	3	320 1608
BRACKET, Mounting (Top Of Evap.).....	59 01.....	1	315 7192
STRAP, Mounting ("L" Shape).....	59 01.....	2	315 7191
HOSE, Drain.....	59 01.....	1	315 7252
GASKET, Rear Plate (Upper).....	59 10-20-80.....	1	343 0811
(Lower).....	59 10-20-80.....	1	343 0812
SCREW, Mounting Bracket.....	59 01.....	2	G180016
Strap (Glove Box Panel).....	59 01.....	4	G161895
Drip Pan.....	59 01.....	2	G187303
Drain Pan.....	59 01.....	6	800 0107
To Dash Panel.....	59 10-20-80.....	4	G162013
SCREW, Face Panel To Housing.....	59 01.....	4	320 1992
Front Plate To Core.....	59 10-20-80.....	3	800 0091
To Side Plate.....	59 10-20-80.....	4	800 0091
To Rear Plate.....	59 10-20-80.....	2	800 0091
WASHER (Lock), Mounting.....	59 01.....	1	G120214
Bracket To Evaporator.....	59 01.....	2	G120380
NUT (Flat Latch).....	59 10-20-80.....	12	G445312
(Speed), Blower Attaching.....	59 10-20-80.....	2	312 6533
To Dash Panel.....	59 10-20-80.....	2	312 6533
Mounting.....	59 01.....	1	G120368
Bracket To Evaporator.....	59 01.....	2	G120375
13.500 DAMPER, Air Conditioning Evaporator Defroster			
DAMPER (Incl. Rod).....	59 10-20-80.....	1	342 5819
ROD.....	59 10-20-80.....	1	342 5820

AMERICAN MOTORS PARTS CATALOG

13,515

GROMMET.....	59 10-20-80.....	1	438 6559
SCREW, Rod To Door.....	59 10-20-80.....	2	G155103
WASHER (Lock), Rod To Door.....	59 10-20-80.....	2	G131096

13.510 DUCT, Air Conditioning Evaporator To Discharge Grille

DUCT (Upper)(Plastic)(Incl..Gasket).....	59 10-20-80.....	1	342 1162
(Left)(Also Used For Mtg. Radio Speaker On Cars Built With Left Speaker).....	59 10-20-80.....	1	342 1979
(Right)(Also Used For Mounting Radio Speaker).....	59 10-20-80.....	1	342 1980
(Lower)(Less Gaskets And Drain Hose).....	59 10-20-80.....	1	314 6342
GASKET (Upper Duct)(17-11/16" Length).....	59 10-20-80.....	1	314 6785
(Lower Duct)(Top)(23-9/16" Length).....	59 10-20-80.....	1	315 5933
(Front)(24-1/8" Length).....	59 10-20-80.....	1	314 6750
Left And Right Ducts To Instru. Panel...	59 10-20-80.....	2	342 2335
Radio Speaker Opening (Less Radio).....	59 10-20-80.....	2	343 1225
COVER, Radio Speaker Opening (Less Radio).....	59 10-20-80.....	2	342 2247
CLIP, Lower Duct To Housing.....	59 10-20-80.....	1	315 4774
HOSE, Drain.....	59 10-20-80.....	1	314 7430
To Discharge Grille (Rubber).....	59 10-20-80.....	2	314 6575
ADAPTER, Drain Hose.....	59 10-20-80.....	1	314 7429
PLATE, Adapter.....	59 10-20-80.....	1	314 7444
SCREW, Upper Duct.....	59 10-20-80.....	8	800 0095
Lower Duct.....	59 10-20-80.....	13	G445626
To Instrument Panel.....	59 10-20-80.....	8	G161860
Cover (Less Radio).....	59 10-20-80.....	8	G161869
WASHER, Adapter.....	59 10-20-80.....	1	800 0179
NUT (Speed), Radio Speaker Opening (Less Radio)	59 10-20-80.....	8	342 8613

13.515 GRILLE, Air Conditioning Air Discharge

GRILLE (Black)(Left).....	59 10-20-80.....	1	342 2291
(Right).....	59 10-20-80.....	1	342 2292
(Blue)(Left).....	59 10-20-80.....	1	343 1543
(Right).....	59 10-20-80.....	1	343 1544
(Green)(Left).....	59 10-20-80.....	1	343 1545
(Right).....	59 10-20-80.....	1	343 1546
(Copper)(Left).....	59 10-20-80.....	1	343 9487
(Right).....	59 10-20-80.....	1	343 9488
DOOR, Air Outlet (Black)(Left).....	59 10-20-80.....	1	342 2299
(Right).....	59 10-20-80.....	1	342 2300
(Blue)(Left).....	59 10-20-80.....	1	343 1547
(Right).....	59 10-20-80.....	1	343 1548
(Green)(Left).....	59 10-20-80.....	1	343 1549
(Right).....	59 10-20-80.....	1	343 1550
(Copper)(Left).....	59 10-20-80.....	1	343 9489
(Right).....	59 10-20-80.....	1	343 9490
PIN, Hinge.....	59 10-20-80.....	4	341 0181
SPRING.....	59 10-20-80.....	4	314 0290
RETAINER, Spring.....	59 10-20-80.....	4	314 0289
SCREW (Long).....	59 10-20-80.....	4	G162406
(Short).....	59 10-20-80.....	4	G162400
NUT.....	59 10-20-80.....	8	G445388